

Sandy Library

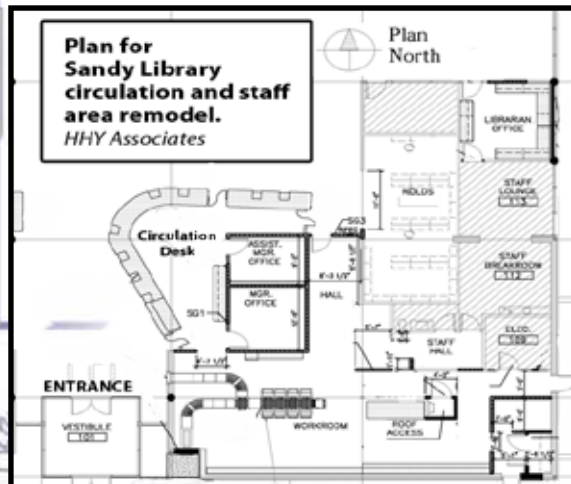

Sandy Library opened its doors for business in 1991 and quickly became a huge hit with the public. At 26,000 sq. ft. Sandy Library is the largest library in the County Library System and circulates the most items (over 1.5 million a year).

After 18 years of booming business, the methods of delivering great library service have evolved. Some needed improvements in Sandy Library's work and traffic flow have been identified and were also noted in a County Library Needs Assessment conducted by Cooper/Roberts Architects in the year 2000.



In 2008 work began to reconfigure the staff sorting and work space, the circulation desk, the room where you pick up your holds and the children's area.

A new heating and air conditioning unit is also being installed on the building's roof.



All areas of the library will remain open for business during the remodel.



The library's present children's area is somewhat hidden and cramped for space.

Past Sandy Library Managers:
Ron Gabriel, Susan Hamada,
Kent Dean, Cheryl Mansen
The current Library Manager is Darin Butler

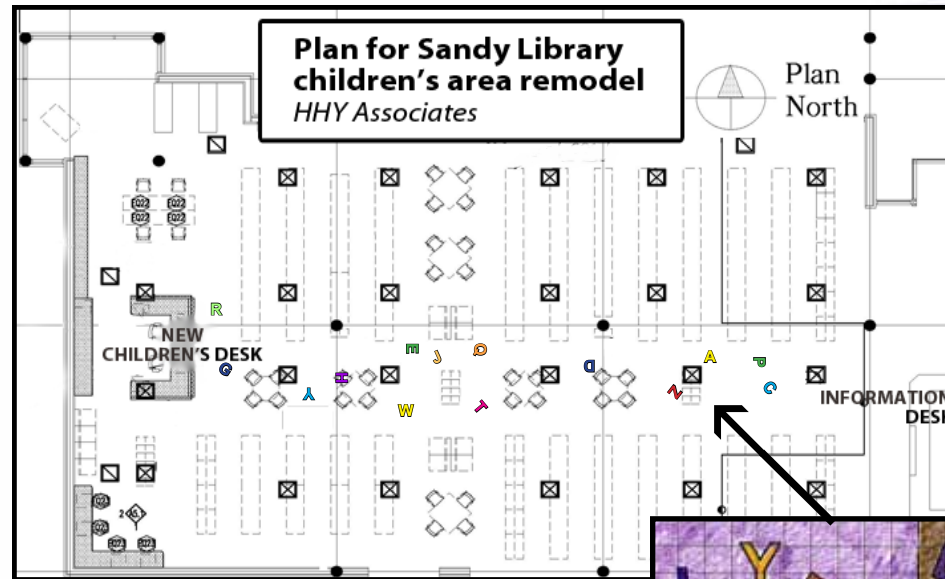

The "path" to the remodeled children's area will have colorful carpet squares with alphabet letters.

